

SOLID RIVETS

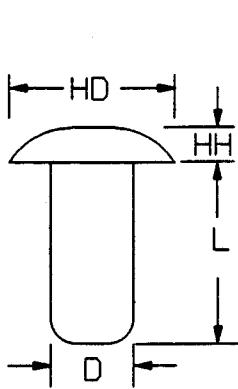

Universal Head

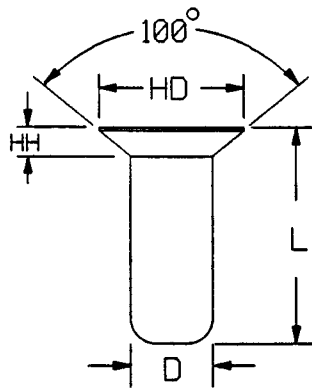

Countersunk Head

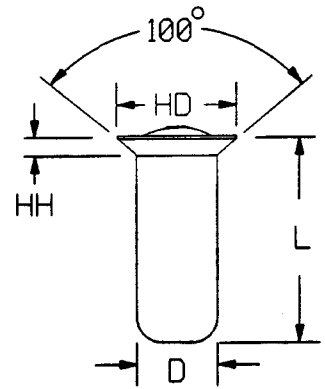

Reduced Countersunk Head

Assortment Kits Available see pages. 231 - 236



Part # Formula, (D) = Diameter in 1/32" (L) = Length in 1/16"

Material	Head Mark/Conversion	Shear Strength	Universal Head	Countersunk Head	Reduced C/S Head
Aluminum 1100-F	NONE / NONE	10 ksi	MS20470A(D)-(L)	MS20426A(D)-(L)	N/A
Aluminum 2117-T4	DIMPLE / NONE	30 ksi	MS20470AD(D)-(L)	MS20426AD(D)-(L)	NAS1097AD(D)-(L)
Aluminum 5056-H32	RAISED CROSS / NONE	28 ksi	MS20470B(D)-(L)	MS20426B(D)-(L)	NAS1097B(D)-(L)
Steel, Cad II Plated	REC. TRIANGLE / .353	25 to 42 ksi	MS20613-(D)P(L)	MS20427-(D)C(L)	N/A
Stainless Steel	NONE / .360	65 to 85 ksi	MS20613C(D)-(L)	MS20427F(D)-(L)	N/A
Monel, No Plating	DOUBLE DIMPLE / .313	49 to 59 ksi	MS20615M(D)-(L)	MS20427M(D)-(L)	N/A
Monel Cad II Plated	DOUBLE DIMPLE / .313	49 to 59 ksi	MS20615MP(D)-(L)	MS20427M(D)C(L)	N/A

DIAMETER DETAILS and PIECES PER POUND

Pieces per pound listed are for aluminum, multiply by conversion factor for other materials.

Diameter #	3		4		5		6		8	
Diameter	.094		.125		.156		.188		.250	
Use Drill	#40		#30		#21		#11		letter F	
Length in 1/16"	Pieces per Pound		Pieces per Pound		Pieces per Pound		Pieces per Pound		Pieces per Pound	
	Universal	Countersunk	Universal	Countersunk	Universal	Countersunk	Universal	Countersunk	Universal	Countersunk
2	6242	8519	3047	4798	1703		1134			
2.5	5496	7183	2725	4048	1545		1032			
3	4909	6209	2484	3497	1413	2097	947		426	
3.5	4435	5468	2249	3080	1302	1862	875		400	
4	4045	4885	2069	2751	1208	1674	813	1094	376	
4.5	3718	4414	1915	2488	1126	1521	780	999	358	
5	3440	4028	1782	2268	1054	1393	713	920	337	
5.5	3200	3701	1667	2085	991	1285	671	852	320	
6	2992	3424	1568	1929	936	1183	634	793	305	412
7	2648	2979	1396	1678	841	1043	571	697	279	365
8	2374	2636	1259	1485	763	927	519	622	257	328
9	2152	2364	1147	1331	699	834	476	561	238	298
10	1968	2143	1053	1207	645	757	440	511	221	273
11	1812	1959	974	1104	596	684	408	469	207	252
12	1680	1805	905	1017	558	641	381	434	194	234
13	1565	1673	848	942	523	595	358	404	183	218
14	1466	1559	794	878	492	555	337	377	173	204
16	1300	1372	708	773	440	489	301	333	157	181
18	1168	1225	637	690	398	438	273	299	143	163
20	1060	1107	579	624	363	396	249	271	131	148
24	865	828	491	522	309	333	213	228	113	125

Documents in this catalog for REFERENCE ONLY, not intended for design. Not guaranteed for accuracy.