

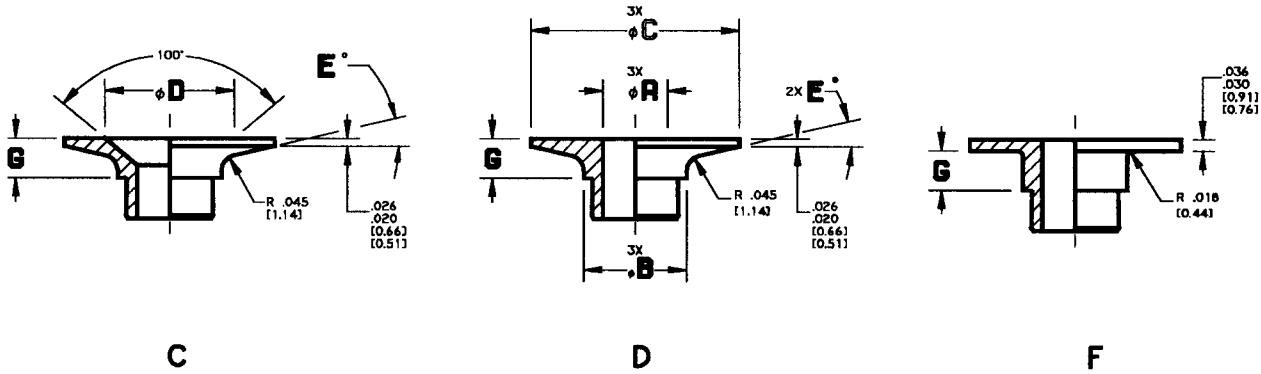

INSERTS FOR METALLIC FACE SKIN PANEL

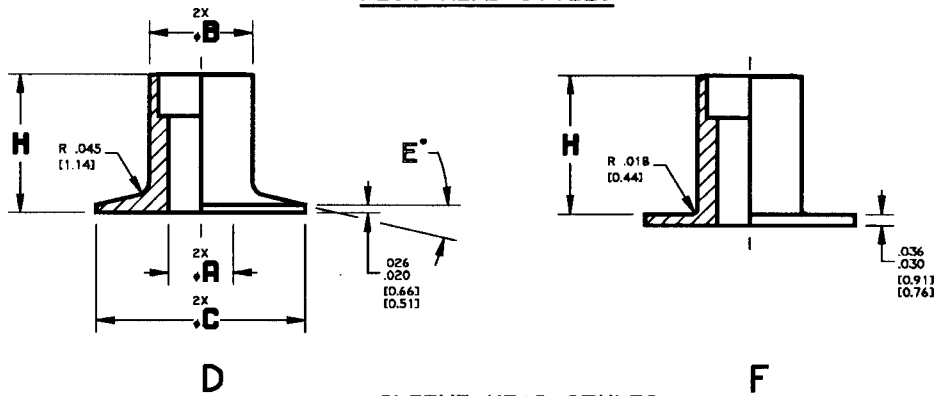

PLUG HEAD STYLES



SLEEVE HEAD STYLES

TABLE II

| MATL CODE | MATERIAL | STANDARD FINISH |
|-----------|-------------------------------------|--|
| 0 | AL ALLOY 2024-T4 PER AMS-QQ-A-225/6 | ANODIZE PER MIL-A-8625, TYPE 1, CLASS 1 |
| 6 | CRES 303 PER ASTM A582 | PASSIVATE PER AMS-QQ-P-35 |
| 7 | TITANIUM PER AMS4928 | NONE |
| 9 | CARBON STEEL PER ASTM A108 | CADMIUM PLATE PER QQ-P-416, TYPE II, CLASS 2 |

EXAMPLE OF PART CODING

SLS 1 0 2 F 10 - 08 AD (INCH)
 SLP 1 0 2 C 10 - 1 AD (INCH)
 SLS 1 0 2 F M5 - 08 AD (METRIC)
 SLP 1 0 2 C M5 - 1 AD (METRIC)

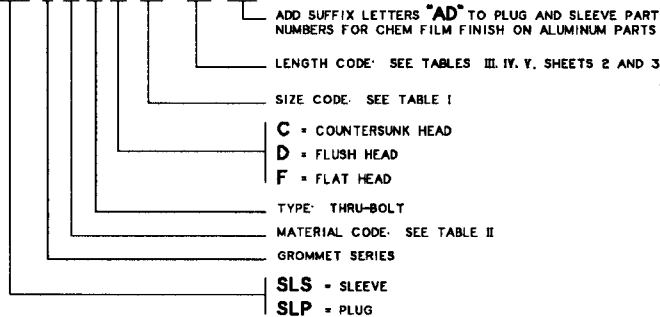

APPLICATION

A MECHANICAL SPACER FOR USE IN PANELS WITH METAL FACE SKINS. INSTALLATION TO BE MADE FROM BOTH SIDES OF PANEL.

TABLE I

| SIZE CODE | .A +.002 [0.05] -.003 [0.08] | .B ± .002 [0.05] | .C | .D +.003 [0.08] -.004 [0.10] | E' |
|-----------|------------------------------------|---------------------|---------------|------------------------------------|-----|
| 4 | .116 [2.95] | .216 [5.49] | .375 [9.52] | .229 [5.82] | 13° |
| 6 | .142 [3.61] | .278 [7.06] | .500 [12.70] | .285 [7.24] | 13° |
| M3 | .122 [3.10] | .278 [7.06] | .500 [12.70] | .236 [6.00] | 13° |
| 8 | .168 [4.27] | .278 [7.06] | .500 [12.70] | .332 [8.43] | 13° |
| M4 | .161 [4.10] | .278 [7.06] | .500 [12.70] | .315 [8.00] | 13° |
| 10 | .194 [4.93] | .309 [7.85] | .625 [15.88] | .385 [9.78] | 13° |
| M5 | .205 [5.20] | .309 [7.85] | .625 [15.88] | .394 [10.00] | 13° |
| 25 | .256 [6.50] | .372 [9.45] | .750 [19.05] | .507 [12.88] | 14° |
| M6 | .244 [6.20] | .372 [9.45] | .750 [19.05] | .472 [12.00] | 14° |
| 31 | .318 [8.08] | .466 [11.84] | .875 [22.28] | .600 [15.24] | 14° |
| M8 | .323 [8.20] | .466 [11.84] | .875 [22.28] | .630 [16.00] | 14° |
| 37 | .381 [9.68] | .622 [15.80] | 1.062 [26.97] | .767 [19.78] | 14° |
| M10 | .406 [10.30] | .622 [15.80] | 1.062 [26.97] | .787 [20.00] | 14° |

NOTES:

- SIZE -25 SLEEVES USED ON .187 PANEL THICKNESS WILL BE SINGLE THRU HOLE.
- ANY COMBINATION OF SLEEVE AND PLUG MAY BE USED.
- "C" HEAD STYLE STANDARD IN PLUG SECTION ONLY.
- SEE SHEETS 2 AND 3 FOR SELECTION OF SLEEVE-PLUG COMBINATIONS FOR GIVEN PANEL THICKNESSES.
- REFER TO SLD100 DATA SHEET FOR INSTALLATION PROCEDURE.
- FASTENERS FOR THICKER PANELS ARE AVAILABLE UPON REQUEST.
- TOLERANCES: .XXX ± .005 [0.13]
ANGLES ± 1°

UNLESS OTHERWISE SPECIFIED
 INTERPRET DIMENSIONS & TOLERANCES PER
 ANSI Y14.5M. ALL DIMENSIONS APPLY AFTER
 PLATING AND PRIOR TO THE ADDITION OF SOLID
 FILM LUBRICANT. 125 [3.2] ALL SURFACES
 TOLERANCES
 .XX .XXX ANGLES [X.X] [X.X X]
 ±.03 ±.010 ±2° ±[0.8] ±[0.25]
 DIMENSIONS IN [] ARE MILLIMETERS

SHUR-LOK CORPORATION
 IRVINE, CALIFORNIA 92614
 TELEPHONE: (949) 474-6000

SHUR-LOK

SHUR-LOK INTERNATIONAL, S.A.
 PETIT-RECHAIN, BELGIUM
 TELEPHONE: (32) 87-32.07.11

INSERT, GROMMET TYPE. THRU-BOLT

SL102

SHEET 1 OF 3

REVISION L 20 OCTOBER 1999

INSERTS FOR METALLIC FACE SKIN PANEL



TABLE III

| SLEEVE | | | | PLUG | | | | PANEL THICKNESS |
|--------------------|-------------------------------------|-------------|------------------|-------------------------------|-------------------------------------|-------------|----------------|------------------|
| TYPE & HEAD | SIZE CODE | LENGTH CODE | H | TYPE & HEAD | SIZE CODE | LENGTH CODE | G | |
| SLS102D SLS102F | 4 6 8 10 M3 M4 M5 | 03 | 103 [2.62] | SLP102C SLP102D SLP102F | 4 6 8 10 M3 M4 M5 | X | .085 [2.16] | .187 [4.75] |
| SLS102D SLS102F | 4 6 8 10 M3 M4 M5 | 04 | 165 [4.19] | SLP102C SLP102D SLP102F | 4 6 8 10 M3 M4 M5 | 0 | .085 [2.16] | .250 [6.35] |
| | | | | | | 1 | .116 [2.95] | .281 [7.14] |
| | | | | | | 2 | .147 [3.73] | .312 [7.92] |
| | | | | | | 3 | .179 [4.55] | .343 [8.71] |
| SLS102D SLS102F | 4 6 8 10 M3 M4 M5 | 06 | 290 [7.37] | SLP102C SLP102D SLP102F | 4 6 8 10 M3 M4 M5 | 0 | .085 [2.16] | .375 [9.52] |
| | | | | | | 1 | .116 [2.95] | .406 [10.31] |
| | | | | | | 2 | .147 [3.73] | .437 [11.10] |
| | | | | | | 3 | .179 [4.55] | .468 [11.89] |
| SLS102D SLS102F | 4 6 8 10 M3 M4 M5 | 08 | 415 [10.54] | SLP102C SLP102D SLP102F | 4 6 8 10 M3 M4 M5 | 0 | .085 [2.16] | .500 [12.70] |
| | | | | | | 1 | .116 [2.95] | .531 [13.49] |
| | | | | | | 2 | .147 [3.73] | .562 [14.27] |
| | | | | | | 3 | .179 [4.55] | .593 [15.06] |
| SLS102D SLS102F | 4 6 8 10 M3 M4 M5 | 10 | 540 [13.72] | SLP102C SLP102D SLP102F | 4 6 8 10 M3 M4 M5 | 0 | .085 [2.16] | .625 [15.88] |
| | | | | | | 1 | .116 [2.95] | .656 [16.66] |
| | | | | | | 2 | .147 [3.73] | .687 [17.45] |
| | | | | | | 3 | .179 [4.55] | .718 [18.24] |
| SLS102D SLS102F | 4 6 8 10 M3 M4 M5 | 12 | 665 [16.89] | SLP102C SLP102D SLP102F | 4 6 8 10 M3 M4 M5 | 0 | .085 [2.16] | .750 [19.05] |
| | | | | | | 1 | .116 [2.95] | .781 [19.84] |
| | | | | | | 2 | .147 [3.73] | .812 [20.62] |
| | | | | | | 3 | .179 [4.55] | .843 [21.41] |
| SLS102D SLS102F | 4 6 8 10 M3 M4 M5 | 14 | 790 [20.07] | SLP102C SLP102D SLP102F | 4 6 8 10 M3 M4 M5 | 0 | .085 [2.16] | .875 [22.22] |
| | | | | | | 1 | .116 [2.95] | .906 [23.01] |
| | | | | | | 2 | .147 [3.73] | .937 [23.80] |
| | | | | | | 3 | .179 [4.55] | .968 [24.59] |
| SLS102D SLS102F | 4 6 8 10 M3 M4 M5 | 16 | 915 [23.24] | SLP102C SLP102D SLP102F | 4 6 8 10 M3 M4 M5 | 0 | .085 [2.16] | 1.000 [25.40] |
| | | | | | | 1 | .116 [2.95] | 1.031 [26.19] |
| | | | | | | 2 | .147 [3.73] | 1.062 [26.97] |
| | | | | | | 3 | .179 [4.55] | 1.093 [27.76] |
| SLS102D SLS102F | 4 6 8 10 M3 M4 M5 | 18 | 1 040 [26.42] | SLP102C SLP102D SLP102F | 4 6 8 10 M3 M4 M5 | 0 | .085 [2.16] | 1.125 [28.57] |
| | | | | | | 1 | .116 [2.95] | 1.156 [29.36] |
| | | | | | | 2 | .147 [3.73] | 1.187 [30.15] |
| | | | | | | 3 | .179 [4.55] | 1.218 [30.94] |

TABLE III CONT'D

| SLEEVE | | | | PLUG | | | | PANEL THICKNESS |
|--------------------|-------------------------------------|-------------|------------------|-------------------------------|-------------------------------------|-------------|----------------|------------------|
| TYPE & HEAD | SIZE CODE | LENGTH CODE | H | TYPE & HEAD | SIZE CODE | LENGTH CODE | G | |
| SLS102D SLS102F | 4 6 8 10 M3 M4 M5 | 20 | 1.165 [29.59] | SLP102C SLP102D SLP102F | 4 6 8 10 M3 M4 M5 | 0 | .085 [2.16] | 1.250 [31.75] |
| | | | | | | 1 | .116 [2.95] | 1.281 [32.54] |
| | | | | | | 2 | .147 [3.73] | 1.312 [33.32] |
| | | | | | | 3 | .179 [4.55] | 1.344 [34.14] |

TABLE IV

| SLEEVE | | | | PLUG | | | | PANEL THICKNESS |
|--------------------|-----------|-------------|-----------------|-------------------------------|-----------|-------------|----------------|-----------------|
| TYPE & HEAD | SIZE CODE | LENGTH CODE | H | TYPE & HEAD | SIZE CODE | LENGTH CODE | G | |
| SLS102D SLS102F | 25 M6 | 03 | .067 [1.70] | SLP102C SLP102D SLP102F | 25 M6 | X | .120 [3.05] | .187 [4.75] |
| SLS102D SLS102F | 25 M6 | 04 | .130 [3.30] | SLP102C SLP102D SLP102F | 25 M6 | 0 | .120 [3.05] | .250 [6.35] |
| | | | | | | 1 | .151 [3.84] | .281 [7.14] |
| | | | | | | 2 | .183 [4.65] | .312 [7.92] |
| | | | | | | 3 | .214 [5.44] | .343 [8.71] |
| SLS102D SLS102F | 25 M6 | 06 | .255 [6.48] | SLP102C SLP102D SLP102F | 25 M6 | 0 | .120 [3.05] | .375 [9.52] |
| | | | | | | 1 | .151 [3.84] | .406 [10.31] |
| | | | | | | 2 | .183 [4.65] | .437 [11.10] |
| | | | | | | 3 | .214 [5.44] | .468 [11.89] |
| SLS102D SLS102F | 25 M6 | 08 | .380 [9.65] | SLP102C SLP102D SLP102F | 25 M6 | 0 | .120 [3.05] | .500 [12.70] |
| | | | | | | 1 | .151 [3.84] | .531 [13.49] |
| | | | | | | 2 | .183 [4.65] | .562 [14.27] |
| | | | | | | 3 | .214 [5.44] | .593 [15.06] |
| SLS102D SLS102F | 25 M6 | 10 | .505 [12.83] | SLP102C SLP102D SLP102F | 25 M6 | 0 | .120 [3.05] | .625 [15.88] |
| | | | | | | 1 | .151 [3.84] | .656 [16.66] |
| | | | | | | 2 | .183 [4.65] | .687 [17.45] |
| | | | | | | 3 | .214 [5.44] | .718 [18.24] |

UNLESS OTHERWISE SPECIFIED
INTERPRET DIMENSIONS & TOLERANCES PER
ANSI Y14.5M. ALL DIMENSIONS APPLY AFTER
PLATING AND PRIOR TO THE ADDITION OF SOLID
FILM LUBRICANT. 125 [3.2] ALL SURFACES
TOLERANCES
.XX .XXX ANGLES [X.X] [X.X X]
±.03 ±.010 ±2° ±[0.8] ±[0.25]
DIMENSIONS IN [] ARE MILLIMETERS

SHUR-LOK CORPORATION
IRVINE, CALIFORNIA 92614
TELEPHONE: (949) 474-6000

SHUR-LOK

SHUR-LOK INTERNATIONAL, S.A.
PETIT-RECHAIN, BELGIUM
TELEPHONE: (32) 87-32.07.11

INSERT, GROMMET TYPE.
THRU-BOLT

SL102

SHEET **2** OF **3**

REVISION L 20 OCTOBER 1999

INSERTS FOR METALLIC FACE SKIN PANEL



TABLE IV CONTD

| SLEEVE | | | | PLUG | | | | PANEL THICKNESS |
|--------------------|-----------|-------------|------------------|-------------------------------|-----------|-------------|----------------|------------------|
| TYPE & HEAD | SIZE CODE | LENGTH CODE | H | TYPE & HEAD | SIZE CODE | LENGTH CODE | G | |
| SLS102D SLS102F | 25 M6 | 12 | .630 (16.00) | SLP102C SLP102D SLP102F | 25 M6 | 0 | .120 (3.05) | .750 (19.05) |
| | | | | | | 1 | .151 (3.84) | .781 (19.84) |
| | | | | | | 2 | .183 (4.65) | .812 (20.62) |
| | | | | | | 3 | .214 (5.44) | .843 (21.41) |
| SLS102D SLS102F | 25 M6 | 14 | .755 (19.18) | SLP102C SLP102D SLP102F | 25 M6 | 0 | .120 (3.05) | .875 (22.22) |
| | | | | | | 1 | .151 (3.84) | .906 (23.01) |
| | | | | | | 2 | .183 (4.65) | .937 (23.80) |
| | | | | | | 3 | .214 (5.44) | .968 (24.59) |
| SLS102D SLS102F | 25 M6 | 16 | .880 (22.35) | SLP102C SLP102D SLP102F | 25 M6 | 0 | .120 (3.05) | 1.000 (25.40) |
| | | | | | | 1 | .151 (3.84) | 1.031 (26.19) |
| | | | | | | 2 | .183 (4.65) | 1.062 (26.97) |
| | | | | | | 3 | .214 (5.44) | 1.093 (27.76) |
| SLS102D SLS102F | 25 M6 | 18 | 1.005 (25.53) | SLP102C SLP102D SLP102F | 25 M6 | 0 | .120 (3.05) | 1.125 (28.57) |
| | | | | | | 1 | .151 (3.84) | 1.156 (29.36) |
| | | | | | | 2 | .183 (4.65) | 1.187 (30.15) |
| | | | | | | 3 | .214 (5.44) | 1.218 (30.94) |
| SLS102D SLS102F | 25 M6 | 20 | 1.130 (28.70) | SLP102C SLP102D SLP102F | 25 M6 | 0 | .120 (3.05) | 1.250 (31.75) |
| | | | | | | 1 | .151 (3.84) | 1.281 (32.54) |
| | | | | | | 2 | .183 (4.65) | 1.312 (33.32) |
| | | | | | | 3 | .214 (5.44) | 1.344 (34.14) |

TABLE V

| SLEEVE | | | | PLUG | | | | PANEL THICKNESS |
|--------------------|-----------------------|-------------|------------------|-------------------------------|-----------------------|-------------|----------------|------------------|
| TYPE & HEAD | SIZE CODE | LENGTH CODE | H | TYPE & HEAD | SIZE CODE | LENGTH CODE | G | |
| SLS102D SLS102F | 31 M8 | 06 | .185 (4.70) | SLP102C SLP102D SLP102F | 31 M8 | 0 | .190 (4.83) | .375 (9.52) |
| | | | | | | 1 | .221 (5.61) | .406 (10.31) |
| | | | | | | 2 | .252 (6.40) | .437 (11.10) |
| | | | | | | 3 | .283 (7.19) | .468 (11.89) |
| SLS102D SLS102F | 31 37 M8 M10 | 08 | .310 (7.87) | SLP102C SLP102D SLP102F | 31 37 M8 M10 | 0 | .190 (4.83) | .500 (12.70) |
| | | | | | | 1 | .221 (5.61) | .531 (13.49) |
| | | | | | | 2 | .252 (6.40) | .562 (14.27) |
| | | | | | | 3 | .283 (7.19) | .593 (15.06) |
| SLS102D SLS102F | 31 37 M8 M10 | 10 | .435 (11.05) | SLP102C SLP102D SLP102F | 31 37 M8 M10 | 0 | .190 (4.83) | .625 (15.88) |
| | | | | | | 1 | .221 (5.61) | .656 (16.66) |
| | | | | | | 2 | .252 (6.40) | .687 (17.45) |
| | | | | | | 3 | .283 (7.19) | .718 (18.24) |
| SLS102D SLS102F | 31 37 M8 M10 | 12 | .560 (14.22) | SLP102C SLP102D SLP102F | 31 37 M8 M10 | 0 | .190 (4.83) | .750 (19.05) |
| | | | | | | 1 | .221 (5.61) | .781 (19.84) |
| | | | | | | 2 | .252 (6.40) | .812 (20.62) |
| | | | | | | 3 | .283 (7.19) | .843 (21.41) |
| SLS102D SLS102F | 31 37 M8 M10 | 14 | .685 (17.40) | SLP102C SLP102D SLP102F | 31 37 M8 M10 | 0 | .190 (4.83) | .875 (22.22) |
| | | | | | | 1 | .221 (5.61) | .906 (23.01) |
| | | | | | | 2 | .252 (6.40) | .937 (23.80) |
| | | | | | | 3 | .283 (7.19) | .968 (24.59) |
| SLS102D SLS102F | 31 37 M8 M10 | 16 | .810 (20.57) | SLP102C SLP102D SLP102F | 31 37 M8 M10 | 0 | .190 (4.83) | 1.000 (25.40) |
| | | | | | | 1 | .221 (5.61) | 1.031 (26.19) |
| | | | | | | 2 | .252 (6.40) | 1.062 (26.97) |
| | | | | | | 3 | .283 (7.19) | 1.093 (27.76) |
| SLS102D SLS102F | 31 37 M8 M10 | 18 | .935 (23.75) | SLP102C SLP102D SLP102F | 31 37 M8 M10 | 0 | .190 (4.83) | 1.125 (28.57) |
| | | | | | | 1 | .221 (5.61) | 1.156 (29.36) |
| | | | | | | 2 | .252 (6.40) | 1.187 (30.15) |
| | | | | | | 3 | .283 (7.19) | 1.218 (30.94) |
| SLS102D SLS102F | 31 37 M8 M10 | 20 | 1.060 (26.92) | SLP102C SLP102D SLP102F | 31 37 M8 M10 | 0 | .190 (4.83) | 1.250 (31.75) |
| | | | | | | 1 | .221 (5.61) | 1.281 (32.54) |
| | | | | | | 2 | .252 (6.40) | 1.312 (33.32) |
| | | | | | | 3 | .283 (7.19) | 1.344 (34.14) |

REVISION L 20 OCTOBER 1999

UNLESS OTHERWISE SPECIFIED
INTERPRET DIMENSIONS & TOLERANCES PER
ANSI Y14.5M. ALL DIMENSIONS APPLY AFTER
PLATING AND PRIOR TO THE ADDITION OF SOLID
FILM LUBRICANT. 125 [3.2] ALL SURFACES
TOLERANCES
.XX .XXX ANGLES [X.X] [X.X X]
±.03 ±.010 ±2° ±[0.8] ±[0.25]
DIMENSIONS IN | ARE MILLIMETERS

SHUR-LOK CORPORATION
IRVINE, CALIFORNIA 92614
TELEPHONE: (949) 474-6000

SHUR-LOK

SHUR-LOK INTERNATIONAL, S.A.
PETIT-RECHAIN, BELGIUM
TELEPHONE: (32) 87-32.07.11

INSERT, GROMMET TYPE. THRU-BOLT

SL102

SHEET **3** OF **3**