

NOTE: When Government drawings, specifications, or other data are used for any purpose other than in connection with a definitely related Government procurement operation, the United States Government hereby makes no warranty, nor any obligation of performance or results, and it is expressly understood that the United States Government assumes no liability for any damages or other claims that may be incurred or sustained by the contractor or other persons in connection with the use of such data.

Approved for Release by NSA on 05-08-2014 pursuant to E.O. 13526

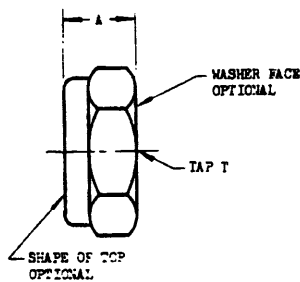
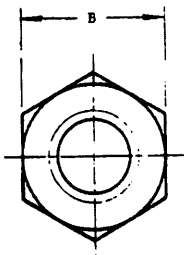

FINE THREAD		DASH NUMBERS	TAP T	S	
STEEL	COPPER BASE ALLOY			A -.016	S -.002 -.010
557		NO. 6-32 NF-2	.125	.312	
836		NO. 5-32 NF-2	.172	.312	
1024	B202	D202	NO. 10-32 NF-3	.172	.375
428	B242	D242	1 1/4 -28 NF-3	.203	.438
524	B524	D524	5/16-24 NF-3	.250	.500
521	B521	D521	3/8-24 NF-3	.250	.563
720	B720	D720	7/16-24 NF-3	.312	.625
820	B820	D820	1/2-20 NF-3	.312	.650
918	B918	D918	5/16-18 NF-3	.350	.675
1018	B1018	D1018	5/8-18 NF-3	.350	.738
1216	B1216	D1216	3/4-16 NF-3	.406	1.063
1414	B1414	D1414	7/8-14 NF-3	.469	1.250
1524	B1524	D1524	1-14 NF-3	.500	1.438
1812	B1812	D1812	1-1/2-12 NF-3	.656	1.625
2012	B2012	D2012	1-3/4-12 NF-3	.750	1.875
COARSE THREAD		DASH NUMBERS	TAP T	S	
STEEL	ALUMINUM ALLOY			A -.016	S -.002 -.010
632	D632	NO. 6-32 NC-2	.125	.312	
832	D832	NO. 5-32 NC-2	.172	.312	
1024	D1024	NO. 10-32 NC-2	.172	.375	

- (a) MENTION A NOT SPECIFIED. LIMITED ONLY BY STRENGTH REQUIREMENT OF SPECIFICATION.
- (b) DASH NOS. 640, 836 AND 1024 FOR FINE THREAD NUTS AND 632 FOR COARSE THREAD NUTS INACTIVE FOR DESIGN AFTER 14 APRIL 1949.
- (c) QUALIFICATION NOT REQUIRED FOR DASH NOS. 640, 836, AND 1024.
- FOR DEFINITION AND APPLICATION OF DRAWING STATUS NOTE SEE AIR BULLETIN NO. 137.
- ADD A AFTER DASH NUMBER FOR NUTS HAVING NON-METALLIC INSERTS.
- ADD C AFTER DASH NUMBER FOR NUTS FABRICATED ENTIRELY FROM METAL.
- EXAMPLES OF PART NOS.: AN364-125 = 1/2-18 STEEL NUT, EITHER ALL METAL OR WITH NON-METALLIC INSERT.
- AN364-125C = 1/2-18 ALUMINUM ALLOY NUT, EITHER ALL METAL OR WITH NON-METALLIC INSERT.
- AN364-125A = 1/2-18 COPPER BASE ALLOY NUT WITH NON-METALLIC INSERT.
- AN364-125B = 1/2-18 STEEL NUT, ALL METAL.
- DIMENSIONS IN INCHES.
- (d) INACTIVE FOR DESIGN AFTER 13 MARCH 1957. USE MS21042, MS21083 OR MS21245.
- FOR INSTALLATION INSTRUCTIONS SEE DRAWING AND NOTES.
- MS21042 PARTS AND PARTS OF LIKE MAIN NUMBERS ARE INTERCHANGEABLE, FUNCTIONALLY AND DIMENSIONALLY INTERCHANGEABLE.
- (e) CANCELED, EXCEPT DASH NOS. 640, 836 AND 1024 AFTER 22 JULY 1969. USE MS21042, MS21083 OR MS21245. SEE THE INTERCHANGABILITY TABLE ON THESE STANDARDS FOR SUBSTITUTIVE PARTS.

PROCUREMENT SPECIFICATION (a) MIL-N-25027	AIR FORCE-NAVY AERONAUTICAL STANDARD	<h1>AN364</h1>
	NUT—SELF LOCKING, THIN, 250° F	

SUPersedes ORAF DRAWING 364 AND NAF DRAWING 1137

APPROVED 9 Apr 65 REVISED 1 14 Apr 49 2 13 Mar 57 3 5 Sep 58 4 22 July 69